



Artist impression of Yan Yean Road near Worns Lane, Yarrambat
15 year progression

YAN YEAN ROAD UPGRADE STAGE 2

ACCESS CHANGES

We're upgrading Yan Yean Road to help you get home safer and sooner

Changes to the way you travel

There will be access changes to Yan Yean Road. Once the upgrade is complete, you'll only be able to turn left in and left out of the majority of local roads and properties along Yan Yean Road. Right turns and U-turns will only be possible at one of the eight intersections that will be upgraded along the road.

This will greatly improve traffic flow and safety by directing traffic to designated intersections and preventing drivers from attempting risky and uncontrolled right turns.

To further improve safety for road users, when we widen Yan Yean Road, we'll install safety barriers in the centre medians and by the roadside. This will significantly reduce the risk of head-on collisions and run off road crashes.

The project will noticeably change the way you travel around your local area. You'll still be able to turn left or right at any of the eight designated intersections shown on the map on the following page.

Everywhere else, instead of turning right when you enter or exit Yan Yean Road, you'll need to turn left and travel to your nearest U-turn opportunity to safely turn around. Safe U-turn opportunities will be provided at the following intersections along Yan Yean Road:

- Kurrak Road (upgraded with traffic lights during Stage 1 of the project)
- Heard Avenue (roundabout to facilitate all large and heavy vehicle U-turns)
- North Oatlands Road (traffic lights)
- Ironbark Road (traffic lights)



- Youngs Road (roundabout to facilitate all large and heavy vehicle U-turns)
- Bannons Lane (traffic lights)
- Jorgensen Avenue (traffic lights with jug handle turn to facilitate large vehicle U-turns up to 14.5m in length)
- Orchard Road (traffic lights)
- Bridge Inn Road (traffic lights).

Some community members might find that they're having to travel a slightly further distance to get where they need to go. Although this may mean a little longer travel distance, overall your journey will become more reliable, quicker and much safer once the road is upgraded.



SIGN UP FOR PROJECT UPDATES
roadprojects.vic.gov.au

Authorised by the Victorian Government, 1 Treasury Place, Melbourne





EES Documentation

The EES is on display for public comment from 31 August to 9 October 2020. Commenting on the EES gives you a chance to have your views considered in planning approvals decisions for Yan Yean Road Upgrade – Stage 2.

You can read the EES online or request a copy on USB. For more information about the EES process, where to read the documents and how to make a submission visit roadprojects.vic.gov.au/yyr-ees.

Accessing facilities along Yan Yean Road

During the community consultation phase in May 2020, we received a number of enquiries from the community asking about access arrangements for popular community facilities and businesses along Yan Yean Road. This included Yarrambat Park Golf Course, Yarrambat Park and Yarrambat Primary School.

In addition to the map above, we've developed the map on the opposite page to demonstrate how you'll be able to access the Yarrambat Park Golf Course as an example, once the road upgrade is complete.

As shown:

- left turn access will be available for those travelling north on Yan Yean Road
- those travelling south on Yan Yean Road wanting to access the golf club can U-turn at the Youngs Road roundabout
- those leaving the golf club and wanting to travel south on Yan Yean Road can U-turn at Bannons Lane. If you're travelling in a larger vehicle (such as a truck or vehicle with a trailer), the nearest suitable U-turn opportunity is Jorgensen Avenue.

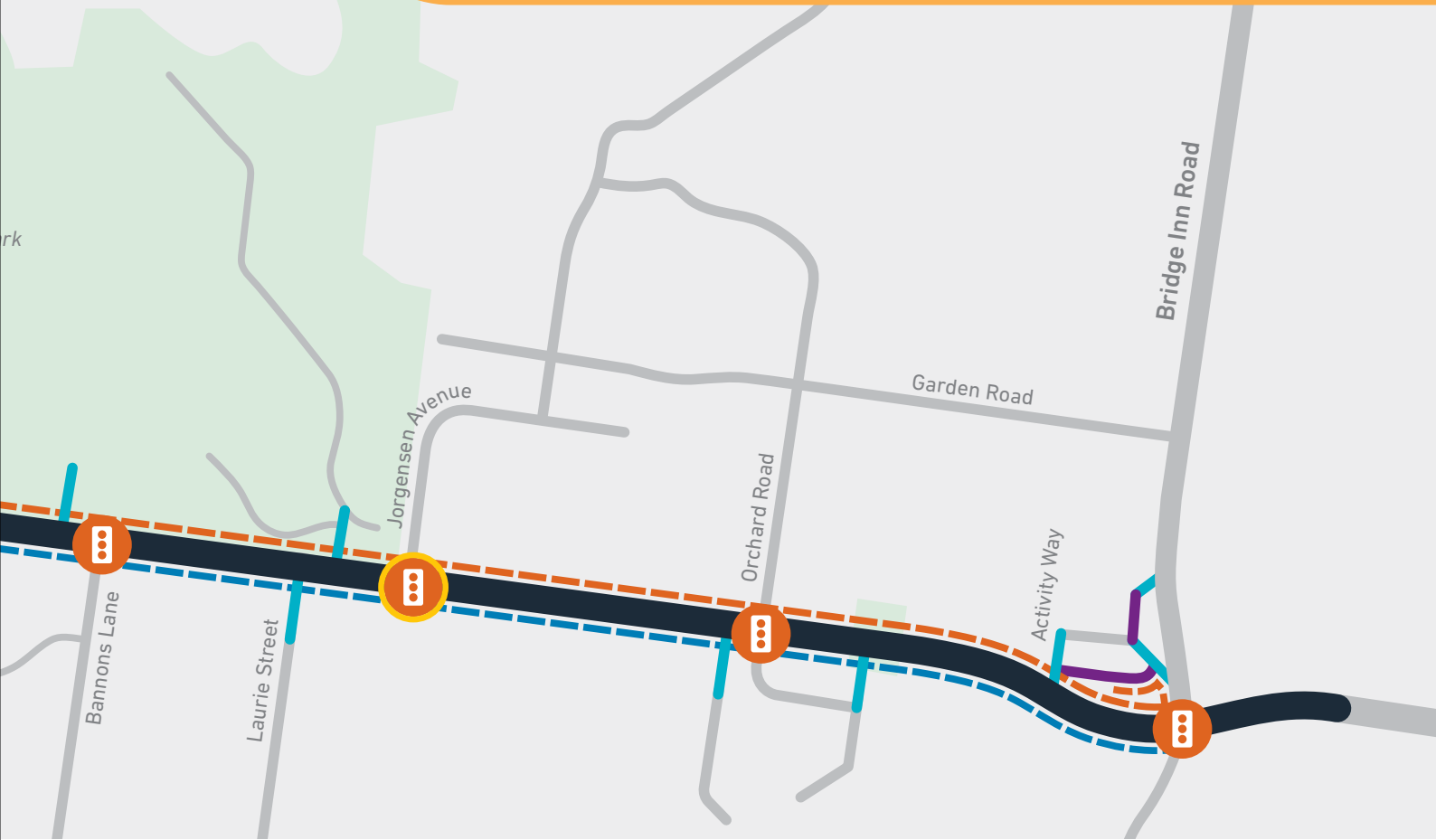

Access to Yarrambat Park Golf Course

Yarrambat Park Golf Course ↑

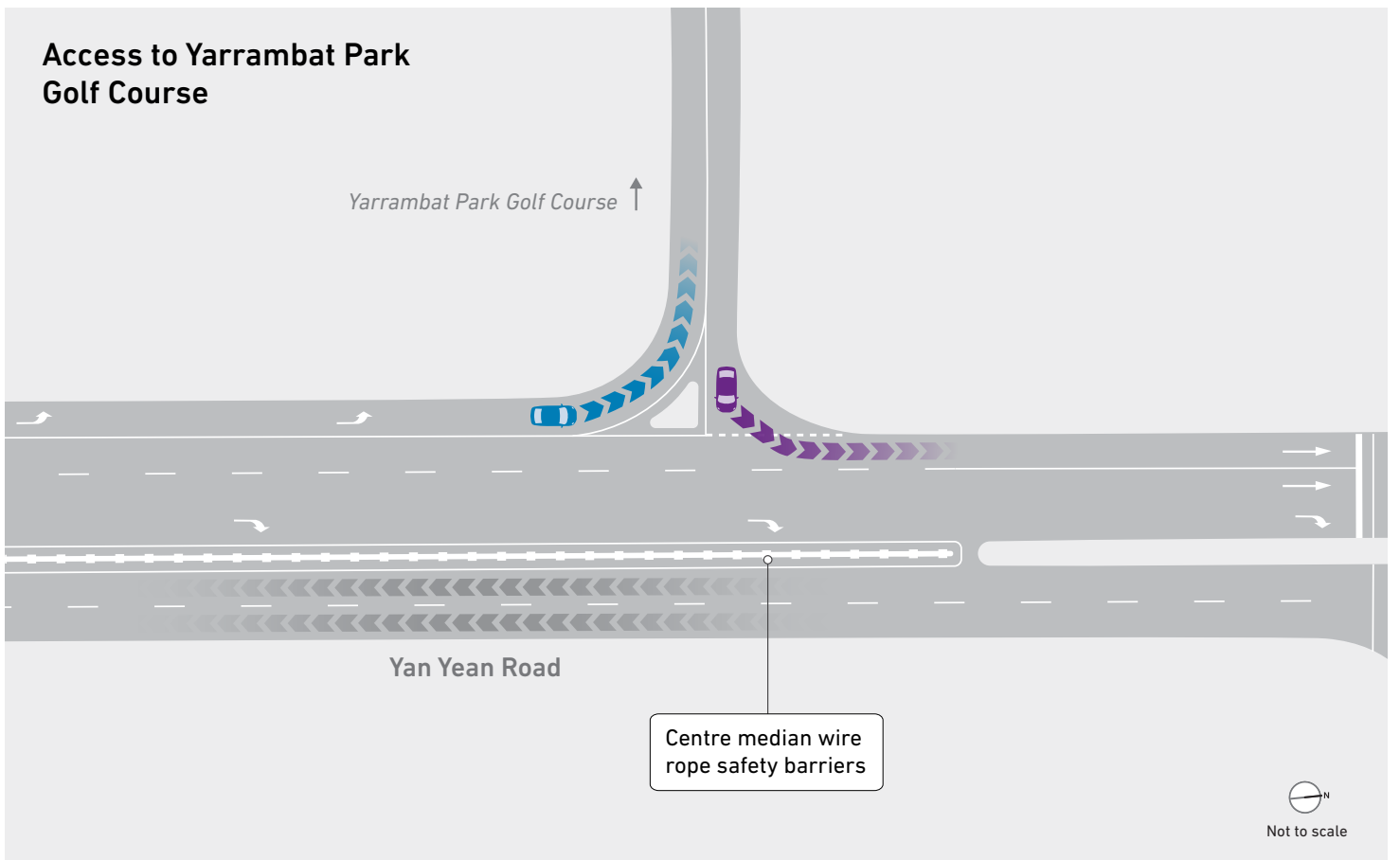

Bridge Inn Road intersection design

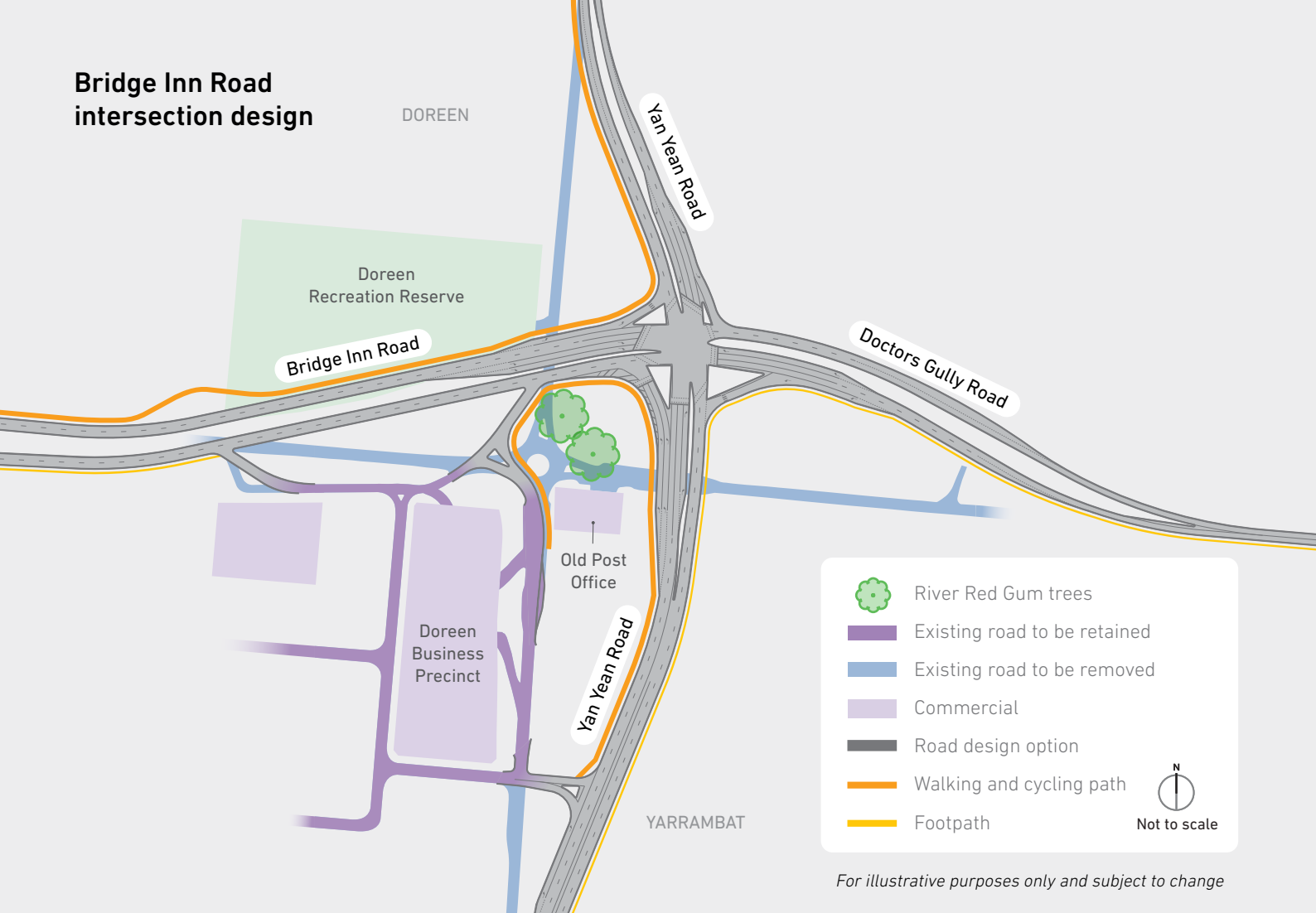

For illustrative purposes only and subject to change

Businesses near Bridge Inn Road

Access to the businesses near the Bridge Inn Road intersection will also change. Following detailed technical investigations and feedback received from the community, we're proposing to construct the new Bridge Inn Road intersection to the north east of its current position.

This means we can build the intersection without removing the two River Red Gum trees on the corner of Doctors Gully Road and Yan Yean Road, which you told us were of great significance to the community.

Access to the Doreen Business Precinct on the south west corner of Yan Yean Road and Bridge Inn Road will change due to the upgrade:

- access between Activity Way and Yan Yean Road will remain left in, left out (as it is now). Instead of accessing Activity Way directly from Yan Yean Road, drivers will enter and exit from a new two-way access road
- access to the Doreen Business Precinct from Bridge Inn Road will become left in, left out only. U-turns are available at the Bridge Inn Road intersection for those travelling east
- cyclists and pedestrians will be able to safely access the Doreen Business Precinct from the new walking and cycling path along the western side of Yan Yean Road.

Moving the Bridge Inn Road intersection to the north east also means we'll be able to retain the old Doreen Post Office building and the two businesses on the south east corner of Doctors Gully Road and Yan Yean Road.

Access to the Doreen General Store and Hadlow and Sons Pet Supplies and Stockfeeds will change:

- access directly onto Yan Yean Road will no longer be possible due to the roadside safety barriers. Safe access for drivers will be provided from a new access road
- pedestrians will be able to safely access these businesses by crossing the new access road.

Contact us

contact@roadprojects.vic.gov.au
1800 105 105

Major Road Projects Victoria
GPO Box 4509, Melbourne VIC 3001

Follow us on social media

     @roadprojectsvic



For languages other than English,
please call 9209 0147

Please contact us if you would like this information in an accessible format

If you need assistance because of a hearing or speech impairment, please visit relayservice.gov.au