



Intersection of Jorgensen Avenue and Yan Yean Road, Doreen

YAN YEAN ROAD UPGRADE STAGE 2

JORGENSEN AVENUE INTERSECTION



We're upgrading Yan Yean Road to help you get home safer and sooner

The intersection of Jorgensen Avenue and Yan Yean Road is not as safe as it could be. Poor sight lines make it difficult for drivers to judge gaps in the traffic and merge with cars travelling 70km/h from a stationary position. This contributes to collisions and near misses at this intersection. To improve safety for road users and the community, the project will upgrade the Jorgensen Avenue intersection.

Design journey

In April 2018, we showed you a design that proposed upgrading the Jorgensen Avenue intersection with a roundabout. Additional technical investigations revealed that an intersection with traffic lights would also improve road safety and traffic flow. In May 2020, we consulted with the community on both of the design options under consideration.

The feedback we received did not show a clear preference for one design over the other, but concerns were raised about horse floats, trailers, caravans and buses being unable to U-turn at Jorgensen Avenue if we installed traffic lights instead of a roundabout.

Updated design

Following consultation with the community and other stakeholders, we developed a hybrid design for the Jorgensen Avenue intersection that will provide the best outcome from a road safety, community and environmental impact perspective.

The new design features a jug handle turn with traffic lights that will:

- improve sight lines for drivers
- provide a safe U-turn opportunity for large vehicles travelling north on Yan Yean Road

- have a smaller footprint than a roundabout, so will have less of an impact on the surrounding environment
- improve safety for pedestrians and road users by providing a signalised intersection and pedestrian crossing.

Safety record

- Poor sight lines and undesirable configuration
- Frequent collisions including serious crashes
- Recognised on the Federal Black Spot list due to fatalities at this intersection.



SIGN UP FOR PROJECT UPDATES
roadprojects.vic.gov.au

Authorised by the Victorian Government, 1 Treasury Place, Melbourne



Jorgensen Avenue intersection design

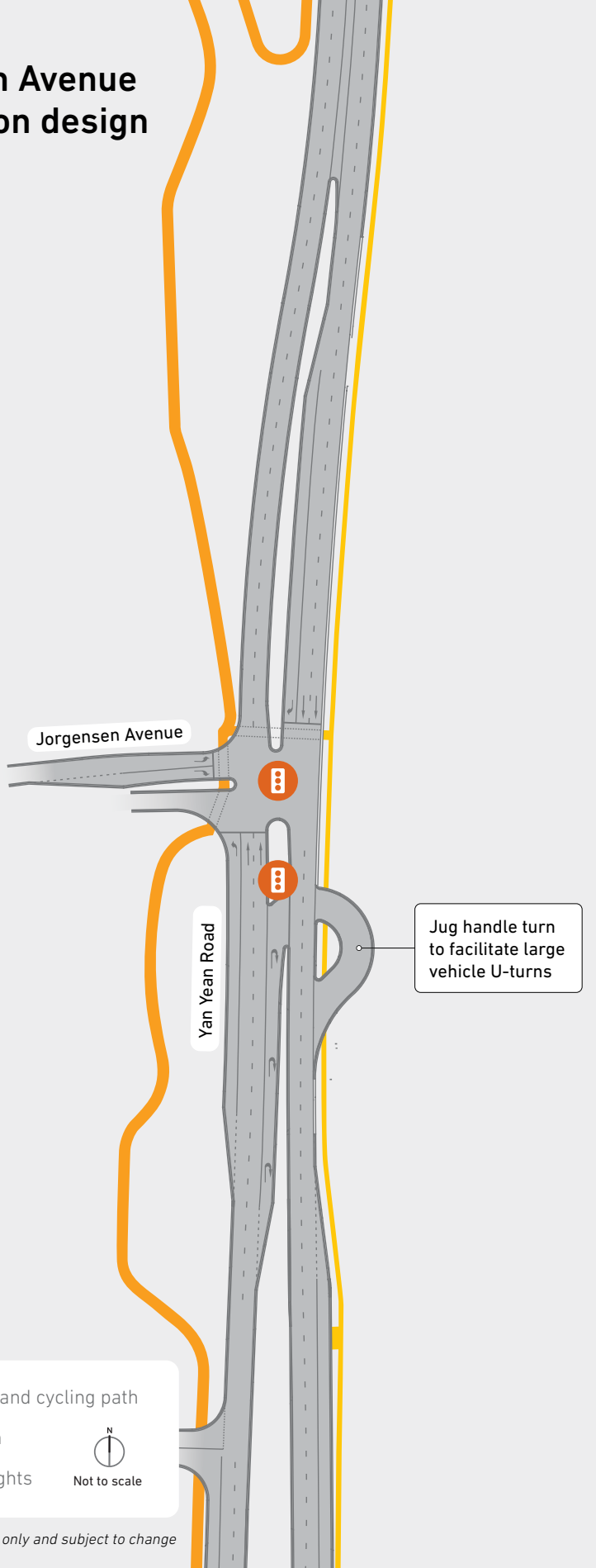

Design progression

- 1 A roundabout was proposed during initial consultation on the design in April 2018
- 2 The project completed additional environmental and technical investigations in the area
- 3 In May, a second design option to upgrade Jorgensen Avenue intersection with traffic lights was considered as an alternative to a roundabout
- 4 Hybrid design developed. Intersection will have traffic lights and a jug handle turn to provide safe U-turns for buses and heavy vehicles.

Have your say

The EES is on display for public comment from 31 August to 9 October 2020. Commenting on the EES gives you a chance to have your views considered in planning approvals decisions for Yan Yean Road Upgrade – Stage 2.

You can read the EES online or request a copy on USB.

For more information about the EES process, where to read the document and how to make a submission visit roadprojects.vic.gov.au/yyr-ees.

- Walking and cycling path
- Footpath
- Traffic lights
- N
- Not to scale

For illustrative purposes only and subject to change

Contact us

contact@roadprojects.vic.gov.au
1800 105 105

Major Road Projects Victoria
GPO Box 4509, Melbourne VIC 3001

Follow us on social media

@roadprojectsvic



For languages other than English,
please call 9209 0147

Please contact us if you would like this information in an accessible format

If you need assistance because of a hearing or speech impairment, please visit relayservice.gov.au